

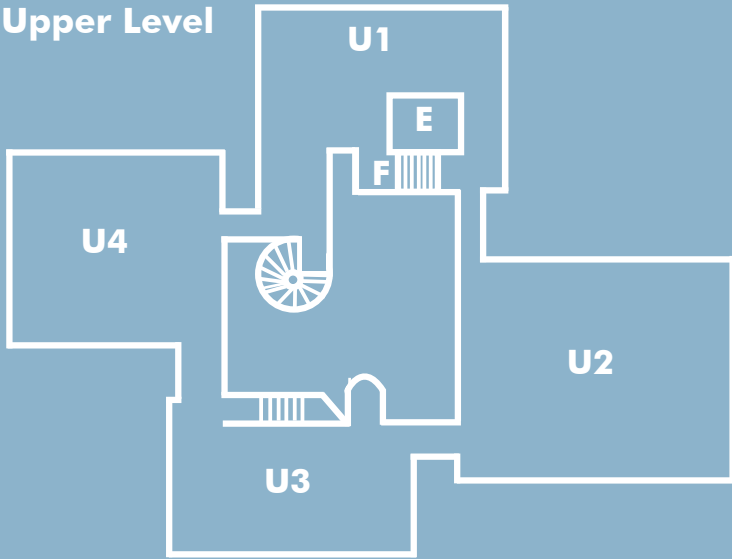

VISITORS' GUIDE

Upper Level



- U1 Coyne Gallery
- U2 Memorial Gallery
- U3 Falcone Gallery
- U4 Williams Gallery

- M1 Beadel Decorative Arts Center
- M2 Rosamond Gifford Sculpture Court
- M3 Museum Shop
- M4 Cloud Wampler Gallery
- M5 Robineau Memorial Gallery
- M6 Members' Council Gallery

- L1 Syracuse China Center for the Study of Ceramics
- L2 Hosmer Auditorium
- L3 Green Room
- L4 International Contemporary Ceramics
- L5 Art Zone
- L6 Administrative Offices
- L7 Hancock Gallery

- MR Mens Restroom
- LR Ladies Restroom
- HR Handicap Restroom
- E Elevator
- F Fire Exit

Main Level

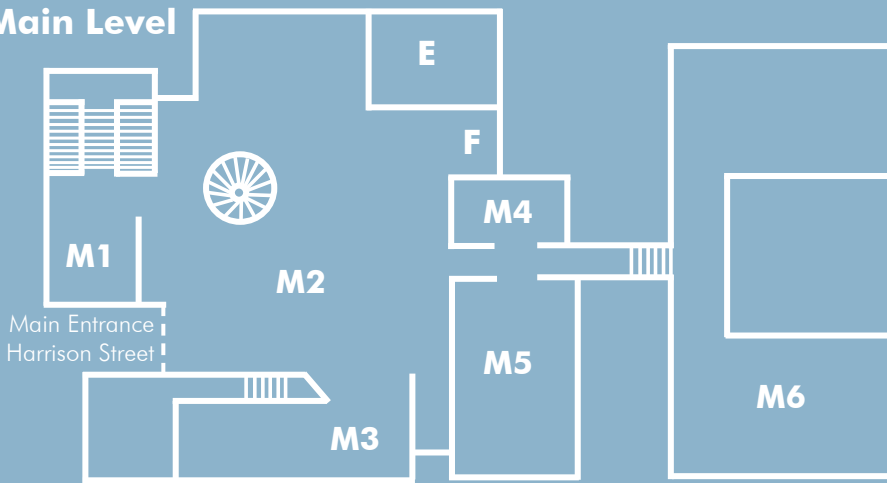

Lower Level

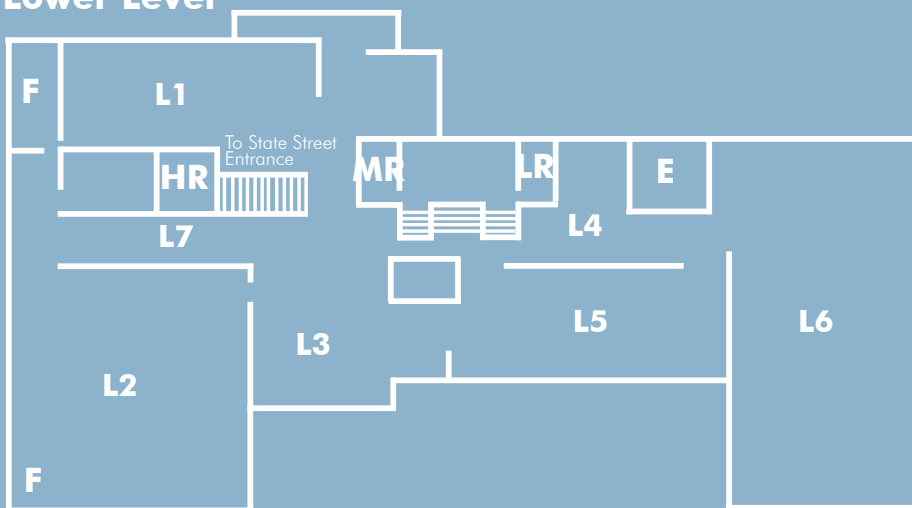

401 Harrison Street
 Syracuse, NY 13202
 (315) 474 6064
www.everson.org

Admission

General admission to the galleries \$5 per person, suggested donation. Tickets are required for certain exhibitions, visit everson.org for ticket information.

Hours

Tuesday - Friday & Sunday: noon - 5.00pm
 Saturday: 10.00am - 5.00pm



EVERSON MUSEUM OF ART

NOW ON VIEW

Good Design: Stories from Herman Miller

August 14 - October 17, 2010 • Upper Level

The Edge of Art: New York State Artists Series Designed to Scale

August 14 - October 24, 2010 • Main Level

The Scarab Vase - Celebrating 100 Years

June 12 - August 29, 2010 • Main Level

Museum Policies

- Food and beverage are not permitted inside the galleries.
- For the safety of the art & visitors, nothing may be carried on your back.
- Items that cannot be carried reasonably and safely must be stored in our lockers. For your convenience, we provide free tokens for the lockers that can be retrieved at either the Museum Shop or Welcome Desk.
- Children may not be carried on the shoulders of another person or in a backpack child carrier. Strollers are permitted inside the galleries.
- The Museum permits photography and videotaping of the permanent collection with permission from the Museum; loaned exhibitions may not be photographed or videotaped. Please see the receptionist in the administrative offices for permission to photograph the permanent collection.
- Do not approach any artwork closer than 24" or in any other way that will endanger it when photographing.
- No electronic flashes or tripods may be used in the Museum.